

CENTERING RINGS

ISO Z-SEAL

NW CENTERING RINGS (STAINLESS STEEL, ALUMINUM AND REDUCING)

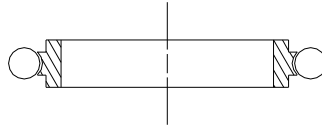

STAINLESS STEEL CENTERING RING WITH BUNA O-RING

PART NUMBER	REFERENCE #	\$ PRICE	O-RING PART #	\$ PRICE (O-RING)
160200	NW-16	4.75	09-0002	0.90
160201	NW-25	5.75	09-0003	0.90
160202	NW-40	8.50	09-0004	0.90
160203	NW-50	10.50	09-0005	0.90

STAINLESS STEEL CENTERING RING WITH ELASTOMER O-RING

PART NUMBER	REFERENCE #	\$ PRICE	O-RING PART #	\$ PRICE (O-RING)
160204	NW-16	5.50	09-0006	3.00
160205	NW-25	6.45	09-0007	3.00
160206	NW-40	10.00	09-0008	4.00
160207	NW-50	13.00	09-0009	5.00

ALUMINUM CENTERING RING WITH ELASTOMER O-RING

PART NUMBER	REFERENCE #	\$ PRICE	O-RING PART #	\$ PRICE (O-RING)
160208	NW-16	4.00	09-0006	3.00
160209	NW-25	5.00	09-0007	3.00
160210	NW-40	7.00	09-0008	4.00
160211	NW-50	9.00	09-0009	5.00

ALUMINUM CENTERING RING WITH BUNA O-RING

PART NUMBER	REFERENCE #	\$ PRICE	O-RING PART #	\$ PRICE (O-RING)
160212	NW-16	4.50	09-0002	0.90
160213	NW-25	5.00	09-0003	0.90
160214	NW-40	4.50	09-0004	0.90
160215	NW-50	5.00	09-0005	0.90

REDUCER CENTERING RING - ALUMINUM WITH BUNA O-RING

PART NUMBER	FITS FLANGE SIZES	\$ PRICE	O-RING PART #	\$ PRICE (O-RING)
160216	NW-10 to NW-16	7.00	09-0004	0.90
160217	NW-20 to NW-25	9.00	09-0005	0.90

REDUCER CENTERING RING - STAINLESS STEEL WITH ELASTOMER O-RING

PART NUMBER	FITS FLANGE SIZES	\$ PRICE	O-RING PART #	\$ PRICE (O-RING)
160218	NW-10 to NW-16	8.00	09-0006	3.00
160219	NW-20 to NW-25	10.00	09-0007	3.00