

FEEDTHROUGHS

MAGNETICALLY COUPLED LINEAR-ROTARY MANIPULATOR

LINEAR MOTION MICROMETER CONTROL

PUSH-PULL LINEAR MOTION FEEDTHROUGH

- Type 304 stainless steel construction
- Actuator removable for bakeout
- Welded bellows seal
- Position lock

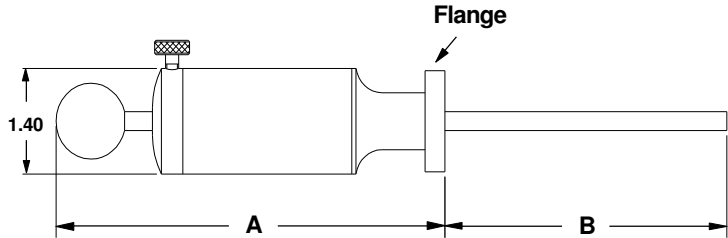

PART NUMBER	REFERENCE NUMBER	FLANGE TYPE	LINEAR TRAVEL	A	B	PRICE \$
170100	HVLM-133-1	Z-Seal Mini	1	6.5 - 7.5	3.5 - 4.5	370
170101	HVLM-275-1	Z-Seal 2 3/4	1	6.5 - 7.5	3.5 - 4.5	370
170102	VLM-NW-16-1	NW-16	1	6.5 - 7.5	3.5 - 4.5	370
170103	VLM-NW-25-1	NW-25	1	6.5 - 7.5	3.5 - 4.5	370
170104	VLM-NW-40-1	NW-40	1	6.5 - 7.5	3.5 - 4.5	380
170105	VLM-NW-50-1	NW-50	1	6.5 - 7.5	3.5 - 4.5	380

ROTARY FEED THROUGH

- All metals exposed to vacuum either 304 or 321 stainless steel
- Welded bellows shaft seal for long life
- Knob is powder coated aluminum
- Stainless steel precision bearings standard
 - Bushing for high speed (optional)

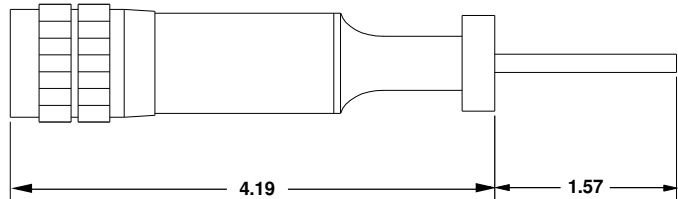

PART NUMBER	REFERENCE NUMBER	DESCRIPTION	PRICE \$
170106	RFT-250-133	Mounted on a mini-flange as pictured	395
170107	RFT-250-133-B	Same as above with bushing	435
170108	RFT-250-275	Mounted on 2 3/4" Z-Seal flange	395
170109	RFT-250-275-B	Same as above with bushing	435

The model RFT-250 is a wobble type rotary feedthrough using a stainless steel bellows for the shaft seal. The feedthrough is available with either precision stainless steel ball bearings throughout or if the feedthrough is to be used for high speed, a beryllium copper bushing replaces two of the shaft bearings.